

# JURCEM<sup>®</sup> HYDROSCREED

## 裕昇防水型地面找平砂浆

Waterproof Floor Screed



JURCEM HYDROSCREED is a premium quality cement-based screed with good waterproofing, adhesion and workability properties.

It is especially intended for medium to thick screed application for wet-areas before tiling and levelling to specific thickness. For complete waterproofing package, it is recommended to apply JURCEM HYDROFLEX (a flexible cementitious waterproofing membrane) before screeding of JURCEM HYDROSCREED to all covered and open wet-areas such as bathroom, kitchen, pit, roof and balcony etc.

This product should not be applied on painted substrates.

### TYPICAL PROPERTIES

Colour	Grey
Binder Phase	Portland Cement
Filler Materials	Graded Silica Sand
Density (wet)	Approx. 2,000 kg/m <sup>3</sup>
Compressive Strength, ASTM C109:2002	≥ 25 N/mm <sup>2</sup> @ 28 days
Flow, ASTM C1437:2001	80% to 120%
Water absorption, ASTM C413:2001	< 5%
Water penetration under 0.2 kgf/cm <sup>2</sup> , DIN 1048:Part 5:1991	< 5 mm
Flexural Strength, ASTM C348:2002	> 2 N/mm <sup>2</sup>
Water Retentivity, BS 4551: Part 1:1998	> 90%
Stiffening Time, BS EN 1015-9:1999 (Method A)	1.0 N/mm <sup>2</sup> : ≤ 360 mins 2.0 N/mm <sup>2</sup> : ≤ 420 mins
Pot Life	1 hour
Quantity of water	5 to 6.2 litres of water per 40 kg bag
Coverage	Approx. 1.2 m <sup>2</sup> / 40 kg bag / 20 mm thickness
Coat thickness	20 to 40 mm per coat

### AREAS OF APPLICATION

1. Interior and exterior floorings for water tight requirement
2. Backing screed to floor
3. Screed for wet area

### APPLICATION METHOD

#### Surface Preparation

The substrate must be clean and free of grease and loose particles. Porous and absorbent substrates must be pre-wetted prior to application of JURCEM HYDROSCREED to prevent premature loss of water to the substrate. This will ensure that thin layers can be applied without cracking. Addition of curing compound or usage of a plastic sheet to cover the finished surface is recommended.

### Mixing

Use about 5 to 6.2 litres of water per 40 kg bag of JURCEM HYDROSCREED. Pour the powder while mixing for at least 3 minutes with an electrical or mechanical mixer to achieve a good trowellable consistency. Do not overmix.

### Placing

Mix required amount and pour screed onto the substrate, using some pressure while finishing with wooden straightedge and float or steel trowel if smoother finishes is required.

For complete waterproofing package, it is recommended to coat immediate substrates with JURCEM HYDROFLEX, left cure for at least a day before application of JURCEM HYDROSCREED at minimum thickness of 20mm.

### Typical Application for JURCEM HYDROSCREED on Wet/Dry Area

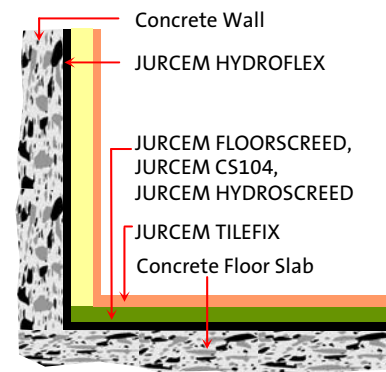

NOTE: HDB's requirement for Wet Area inclusive of JURCEM HYDROSCREED and JURCEM HYDROFLEX. These items are not required for dry area.

### Cleaning

Clean tools with water immediately after use. Cured materials can only be removed mechanically.

### PACKAGING

40 kg bag

### SHELF LIFE

12 months if stored in original sealed packaging under dry and cool condition.

### SAFETY PRECAUTIONS

JURCEM HYDROSCREED is non-hazardous, but due to the cementitious nature, it is advisable to wear a filter mask and protective clothing. In case of eye contact, wash copiously with water and if irritation persists, seek medical treatment.

For more detailed information, please refer to Material Safety Data Sheet.

JCL Building Materials Pte Ltd (JCL) warrants that the product conforms to its chemical and physical description and is within bounds fit for use as stated on its product data sheet when used in compliance with written instructions. JCL makes no other warranty either expressed or implied. The purchaser assumes all risks in handling.

All information contained in this product data sheet is only to be used as a guide and subject to change without notice. This product data sheet supercedes all previous data sheets of this product. For additional information or concerns about unique applications or specific projects, please contact JCL.