

# JURCEM<sup>®</sup>

## FLOORSCREED

### 裕昇高聚地面找平砂浆

Polymerised Floor Screed



JURCEM FLOORSCREED is a highly premium quality cement-based screed with good water-retention, adhesion and workability properties.

It is especially intended for medium to thick screed or for improving the surfaces of concrete before tiling and levelling to specific ceiling height.

It can also be used as a topping for roof waterproofing membrane and casting of floor slab.

For smooth and levelled floor required for laying of carpet or vinyl tile, JURCEM SELF-FLO UNDERLAYMENT is highly recommended as a coating over JURCEM FLOORSCREED.

JURCEM FLOORSCREED should not be applied on painted substrates.

#### TYPICAL PROPERTIES

Colour	Grey
Binder Phase	Portland Cement
Filler Materials	Graded Silica Sand
Density (wet)	Approx. 2,000 kg/m <sup>3</sup>
Flexural Strength, ASTM C348:2002	> 2N/mm <sup>2</sup> @28 days
Compressive Strength, ASTM C109:2002	≥ 25 N/mm <sup>2</sup> @28 days
Water Absorption, ASTM C413:2001	< 5%
Water Retentivity, BS 4551:Part1:1998	> 90%
Flow, ASTM C1437:2001	80% to 120%
Stiffening Time, BS EN 1015-9:1999 (Method A)	1.0 N/mm <sup>2</sup> – ≤ 360 mins 2.0 N/mm <sup>2</sup> – ≤ 420 mins
Pot Life	1 hour
Quantity of water	5.2 to 6.4 litres of water per 40 kg bag
Coverage	Approx. 1.2 m <sup>2</sup> /40 kg bag / 20 mm thickness
Coat thickness	20 to 40 mm per coat

#### AREAS OF APPLICATION

1. Interior and exterior floor
2. Backing screed to floor tiles
3. Levelling of floor to specific thickness
4. Forming gradient to floor at wet areas to minimise water ponding

#### APPLICATION METHOD

##### Surface Preparation

The substrate must be clean and free from grease and loose particles. Porous and absorbent substrates must be pre-wetted prior to application of JURCEM FLOORSCREED to prevent premature loss of water to the substrate. This will ensure that thin layers can be applied without cracking.

Addition of curing compound such as JURCEM ACRYCURE WB or usage of plastic sheet to cover the finished surface is recommended for proper curing.

##### Mixing

Use 5.2 to 6.4 litres of water per 40 kg bag of JURCEM FLOORSCREED. Pour the powder while mixing for at least 3 minutes with an electrical or mechanical mixer to achieve a good trowellable consistency. Do not overmix.

##### Placing

Mix required amount and pour screed onto the substrate, using some pressure while finishing with long wooden float or steel trowel if smoother finish is required.

Application of JURCEM FLOORSCREED is similar to all other cement mortar mixes or site cement sand mix.

Machine application is possible with JURCEM FLOORSCREED for efficient construction.

#### Typical Application for JURCEM FLOORSCREED on Wet/Dry Area

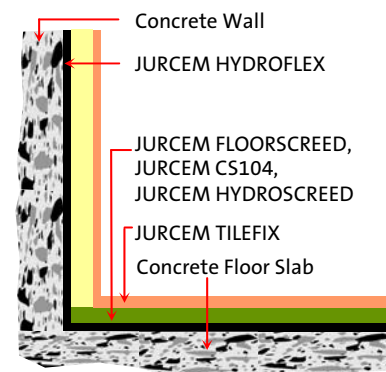

##### Cleaning

Clean tools with water immediately after use. Cured materials can only be removed mechanically.

##### PACKAGING

40 kg bag

##### SHELF LIFE

12 months if stored in original sealed packaging under dry and cool condition.

##### SAFETY PRECAUTIONS

JURCEM FLOORSCREED is non-hazardous, but due to the cementitious nature, it is advisable to wear a filter mask and protective clothing. In case of eye contact, wash copiously with water and if irritation persists, seek medical treatment.

For more detailed information, please refer to Material Safety Data Sheet.

JCL Building Materials Pte Ltd (JCL) warrants that the product conforms to its chemical and physical description and is within bounds fit for use as stated on its product data sheet when used in compliance with written instructions. JCL makes no other warranty either expressed or implied. The purchaser assumes all risks in handling. All information contained in this product data sheet is only to be used as a guide and subject to change without notice. This product data sheet supercedes all previous data sheets of this product. For additional information or concerns about unique applications or specific projects, please contact JCL.